

CONSTRUCTION UPDATE – 5 FEBRUARY 2019

We are removing the first tower crane from the development on Lot 12 (Building 2) at South Eveleigh. The crane will be dismantled using the existing cranes on the site.

What to expect:

The components for the crane will be removed on trucks that will enter the precinct via Garden Street and out Davy Road.

There will be exclusion zones and traffic changes in place on Central Ave during lifting operations. Public pedestrian access will be maintained on Central Ave and access to existing carparks and loading docks will also be maintained.

Work duration:

The works are scheduled to be completed on Saturday 9th February, however progress could potentially be delayed due to unforeseen circumstances such as inclement weather.

If you have any questions or concerns, or if you require more information, please contact <mailto:south.eveleigh@mirvac.com> or call **1800 870 549**.

Kind regards, Kim



Kim Elliott

Communications and Engagement Manager
Office and Industrial

T +61 2 9080 8125
2 Locomotive St, Eveleigh NSW 2015

Reimagine urban life

[Electronic Data Transmission Disclaimer](#)

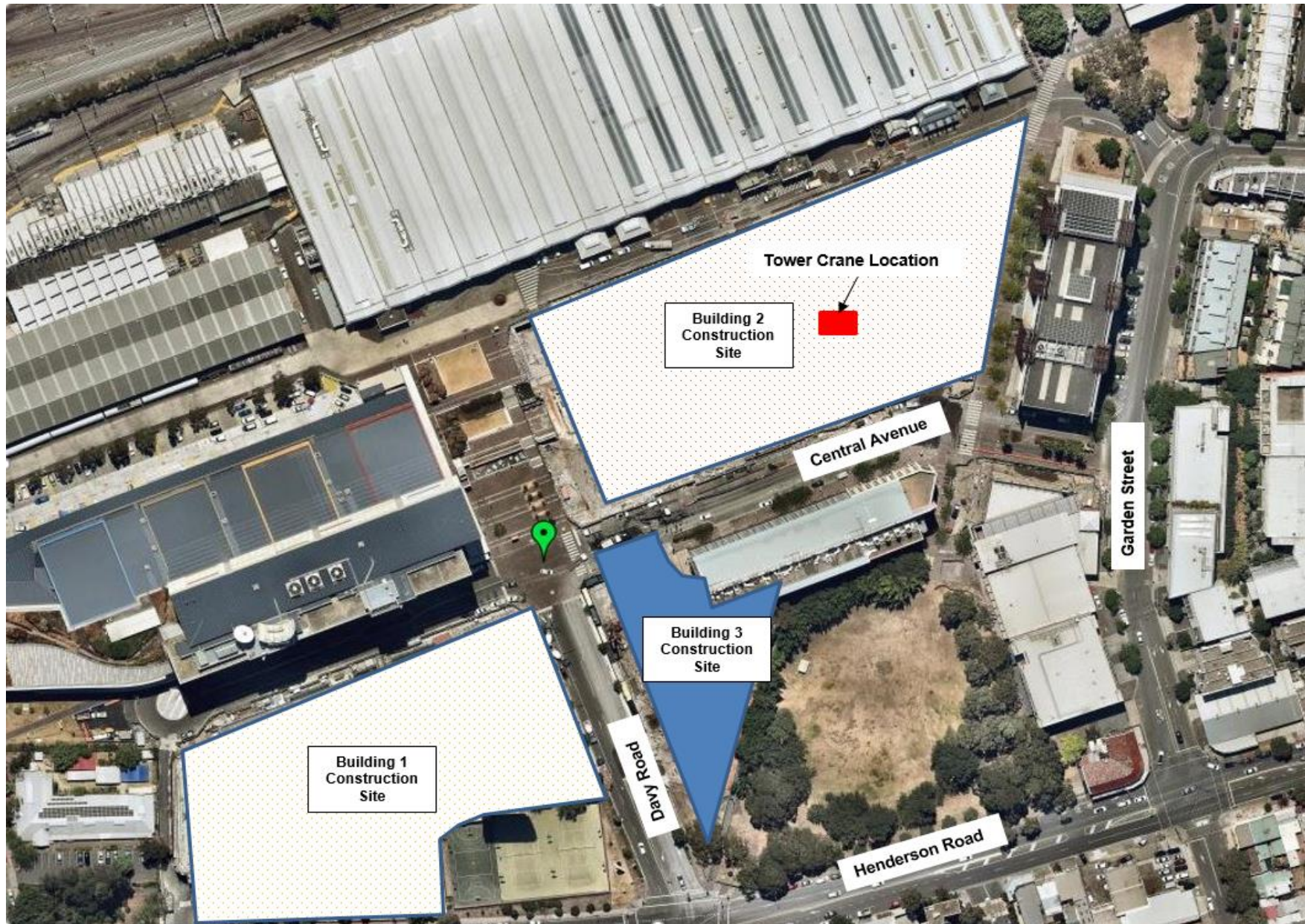

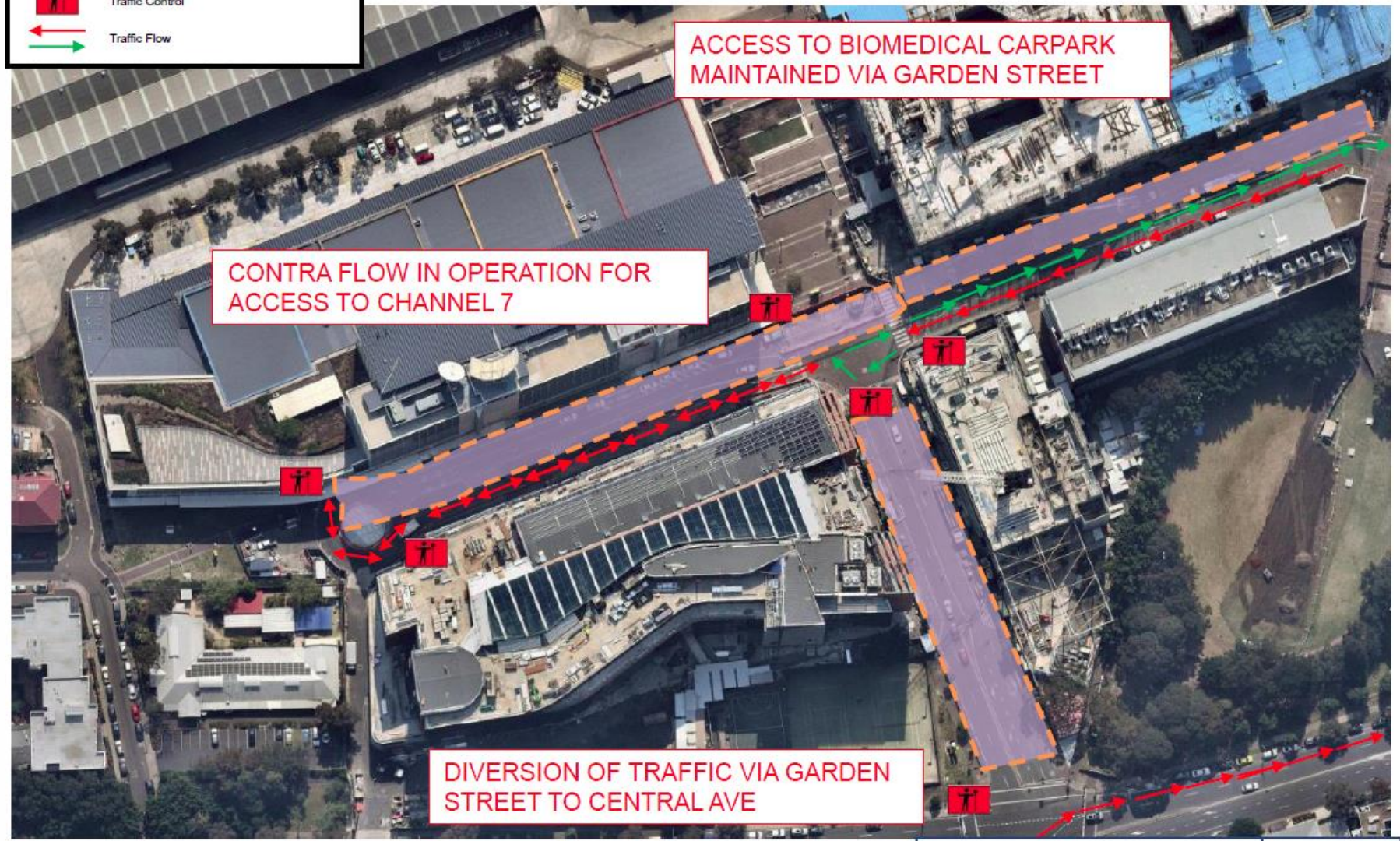

SATURDAY 24/11/18

Australian Technology Park Construction Staging Plans Infrastructure & Public Domain	Revision 03
ATPINF_212F Central Avenue West	Date: 17/11/18